

Profiles for external thermal insulation composite systems "ETICS"

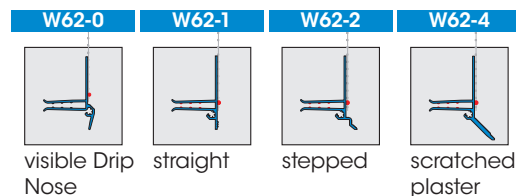

**APU Clasp-on Profiles SOLI-TEX**  
with Drip Edge

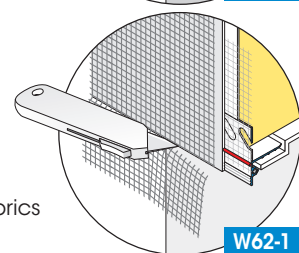
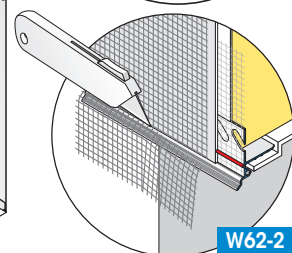
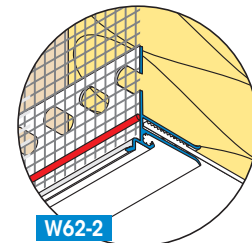
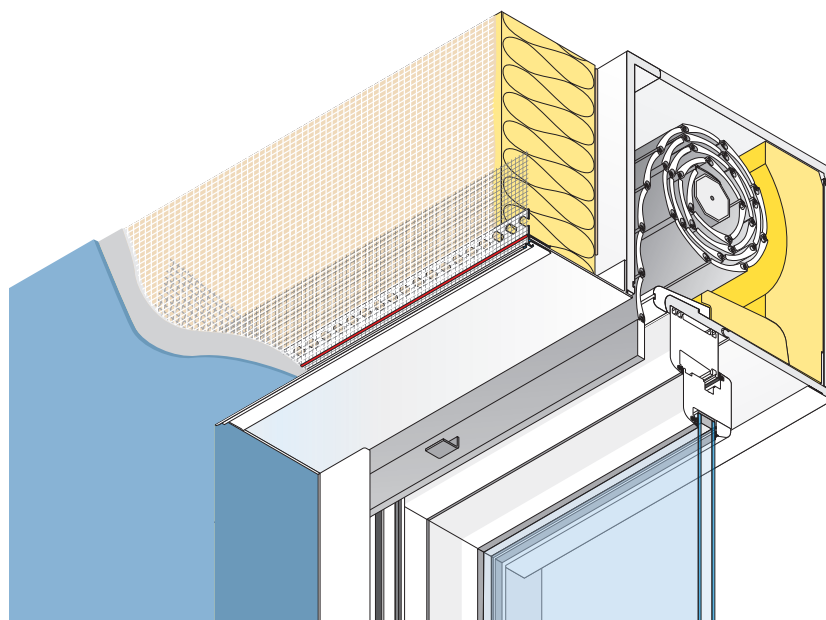

for W62-1 cut overlapping facade fabrics along the **lower edge side**, for the other versions on the grooved surface

Plaster borders in thermal insulation composite systems also require a secure solution with regard to water-guiding and drainage downwards. The APU Clasp-on Profiles SOLI-TEX W62-0, -1, -2 and -4 are used for rails up to 2.5 mm thickness on horizontal plaster borders at revealing component parts. The profiles are formed as covered or visible Drip Edges for advanced drainage. The welded on fabric part forms the force-closed joint with the facade fabric. For improved plaster grip the edges are sloping downward or stepped (W62-0, -2, -4) and grooved (all versions). For wide objects the profiles are joined with Plug Connectors Z13 to enable flush alignment.

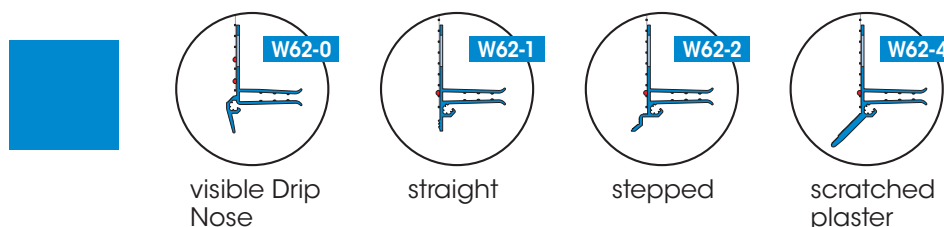

**Available packed unit:**  
10 bars of 2.10 m = 21.00 m  
incl. 25 Plug Connectors

For detailed information see technical information sheet or visit us on the Internet at [www.apu.ch](http://www.apu.ch).