

Application examples

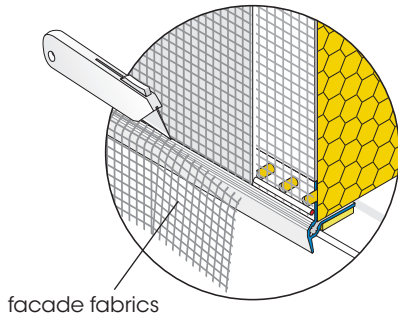

facade fabrics

Processing

- shorten the Connecting Profile with fabric with the Trimming Shears
- cut overlapping facade fabrics on the grooved surface of the Connecting Profile
- cut the Base Rail to size with a **Multimaster tool (FEIN)**

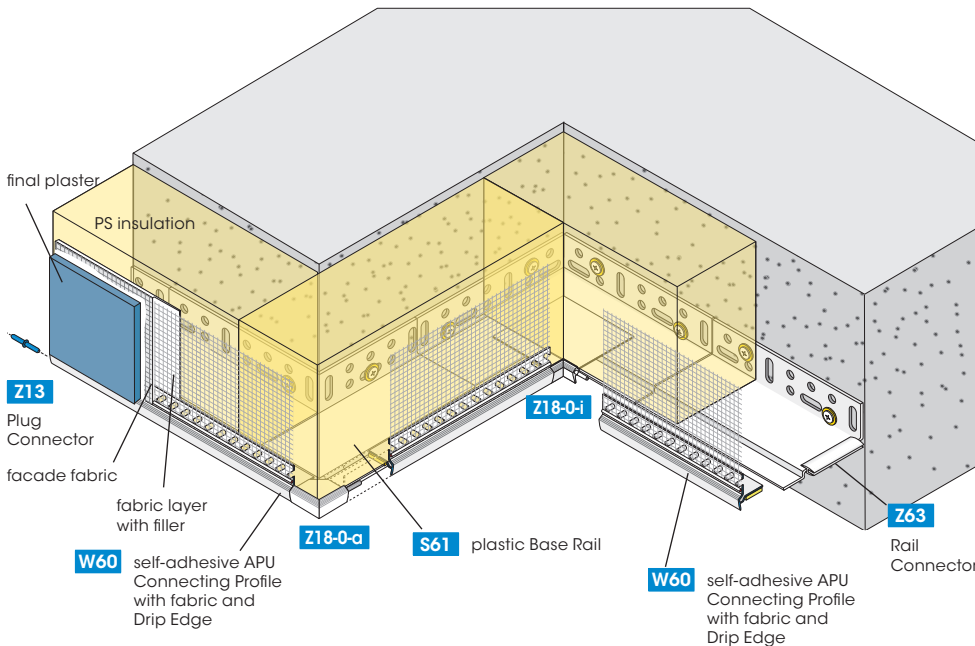

Additional advantages

- convenient processing
- neat plaster border
- flush edges
- well-directed water guiding
- safer system
- reduction of thermal bridging
- absorption of movements in the system

For detailed information see technical information sheet or visit us on the Internet at www.apu.ch.

APU Base Rail System SOLI-TEX

with accessories for insulation thicknesses of 50 to 200 mm

Standard delivery components per packed unit W61

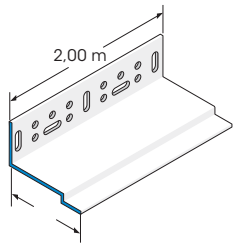

for insulation thicknesses of 50-160 mm

S61 SOLI-TEX Base Rails

for insulation thicknesses of 50-160 mm
10 pieces of 2.00 m per pack

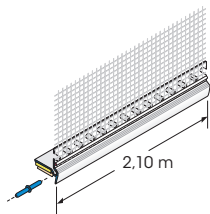

W60 Connecting Profile SOLI-TEX

self-adhesive joint profile with fabric
10 pieces of 2.10 m per pack



Z13 Plug Connectors

enclosed in a bag

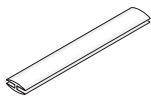

Z61 Rail Connector H-shaped

for 2.5 mm profile wall thickness,
1-2 bars of 2.00 m, per pack, depending on the Base Rail outreach

Accessories optional

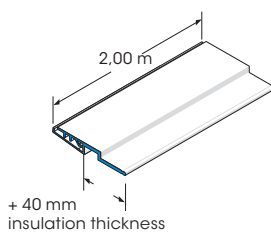

W63 Extension

clasp-on profile for insulation thicknesses > 160 mm up to max. 240 mm (= 2 extensions)
10 pieces of 2.00 m

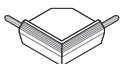

Z18-0-a Corner Element for outer corner

10 pieces/bag
10 bags/pack

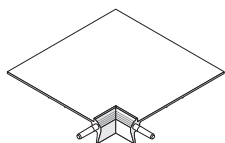

Z18-0-i Corner Element for inner corner

10 pieces/bag
10 bags/pack

Application instructions

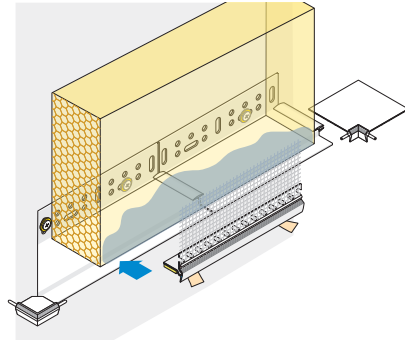

To align the profile with fabrics/Connecting Profile, lift off starter tabs of the Protective Paper from the self-adhesive Sealing Tape approx. 5 cm on both ends to the front of the Connecting Profile (W60) and align it with the insulation board: Push the Connecting Profile under the insulation board (overlapping the contact area between the Base Rails). Pull off Protective Paper completely using the starter tabs and press the Connecting Profile and Base Rail together along their entire length.

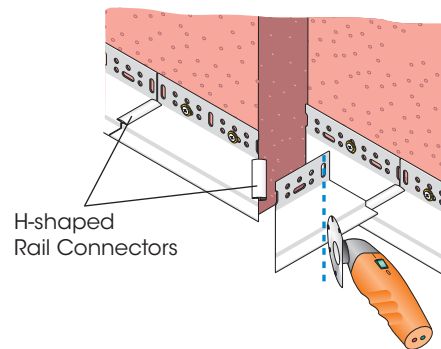

Cut the corner parts of Base Rails in place using a **Multimaster tool** (type FEIN).

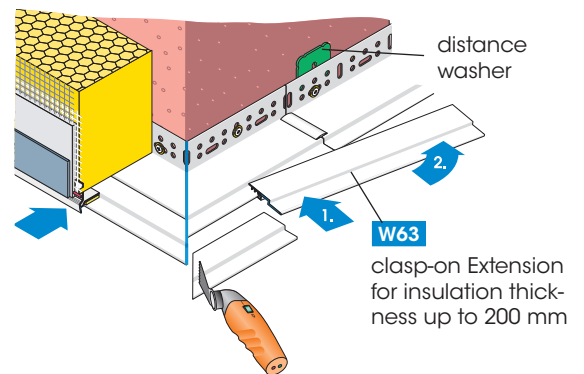

Cut the Extension W63 in the same way and clip it onto the finished mounted Base Rail S61 (first clip on one end, then press the extension towards the other end into position - see illustration - for easier working).

APU Base Rail System SOLI-TEX

with accessories for insulation thicknesses of 50 to 200 mm

Possible profile combinations

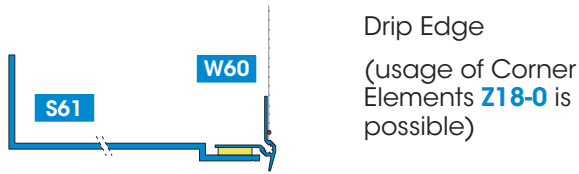

optional

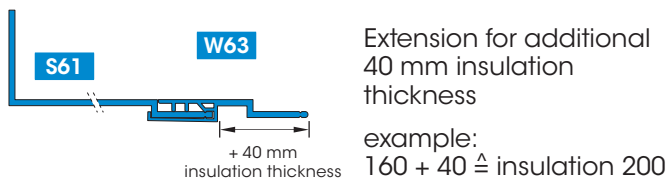

Mounting instruction

- 1 Fix the Base Rail (2.00 m, 50–160 mm) (with impact dowel or similar). For a transition without displacement fix Rail Connectors Z61 between the Base Rails.
- 2 For insulation thicknesses > 160 mm use the Extension W63 (+40 mm).
- 3 Mount the insulation board.
- 4 Mount the delivery included profile with the self-adhesive PE Sealing Tape on the bent tab of the Base Rails, offset at least 10 cm to the contact area between Base Rails as follows: The bending surface must be dry and free from dust. Pull the Protective Paper approx. 5 cm on the left and right, align the Connecting Profile with fabric between the insulation board and Base Rail. Press down on both sides, completely remove the Protective Paper, then press the Connecting Profile with fabric firmly against the Base Rail along its entire length.
- 5 Plug Connectors Z13 are used to make a flush fitting with the Connecting Profiles.
- 6 Corners are formed using Corner Elements Z18-0.

