

Profiles for external thermal insulation composite systems "ETICS"

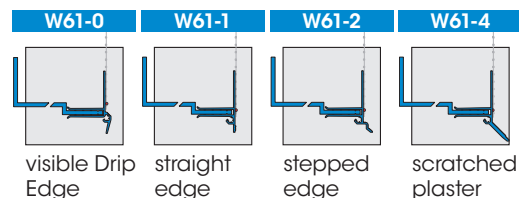

## APU Base Rail SOLI-TEX

Base Rail System made of plastic with Clasp-on Profile with fabrics

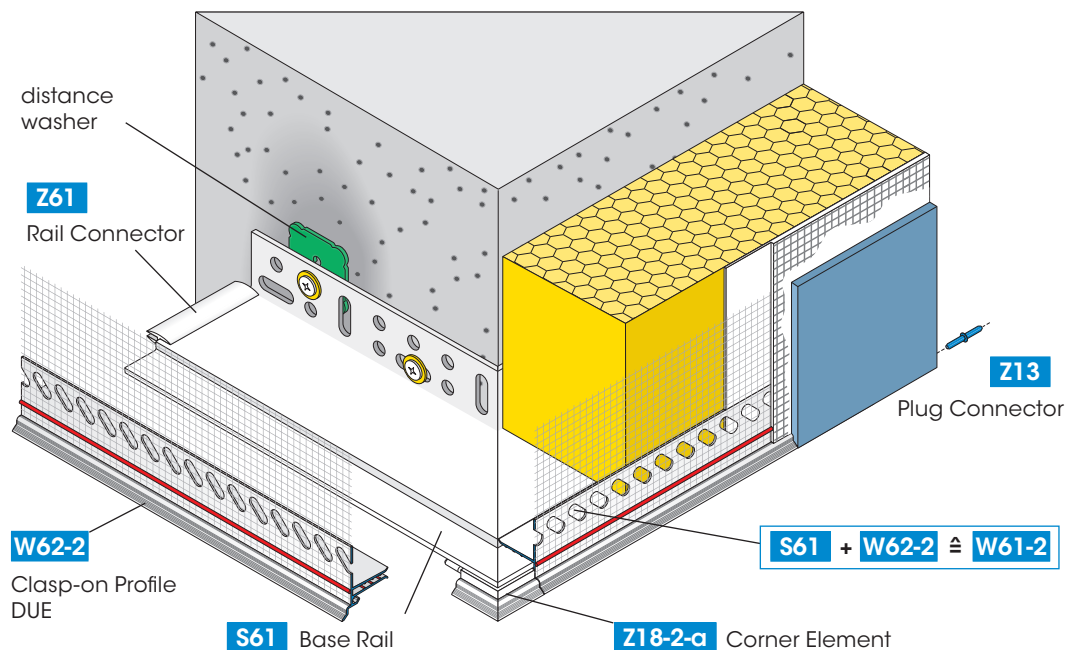

The Base Rails are made of plastic with a stepped bending for taking up its counterpart Clasp-on Profile with fabric 12.5 cm and Drip Edge. It is suitable for insulation thicknesses of 50-200 mm in thermal insulation composite systems with rigid foam/mineral fiber boards and fabric filler of 4-8 mm. For improved adhesion of the plasters the transition to the Drip Edge is grooved.

The plastic Base Rail is fastened mechanically with stamp dowels, the enclosed Clasp-on Profile with fabric is plugged onto the stepped bending, overlapping the contact area between the Base Rails at least 10 cm. Using the Rail Connectors Z61 and the Plug Connector Z13 the components are joined together flush. Corners are formed with the corresponding Corner Elements for inner/outer corners Z18-0 / Z18-1 / Z18-2.

### Available packed unit:

10 bars of 2.00 m = 20.00 m,  
incl. 25 Plug Connectors Z13, Rail Connectors Z61,  
2 Corner Elements for outer and 1 for inner corners  
(detailed assembly see example box next page)

For detailed information see technical information sheet or visit us on the Internet at [www.apu.ch](http://www.apu.ch).