

Profiles for external thermal insulation composite systems "ETICS"

W60

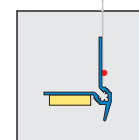

APU Connecting Profile SOLI-TEX
with waterguiding Drip Nose

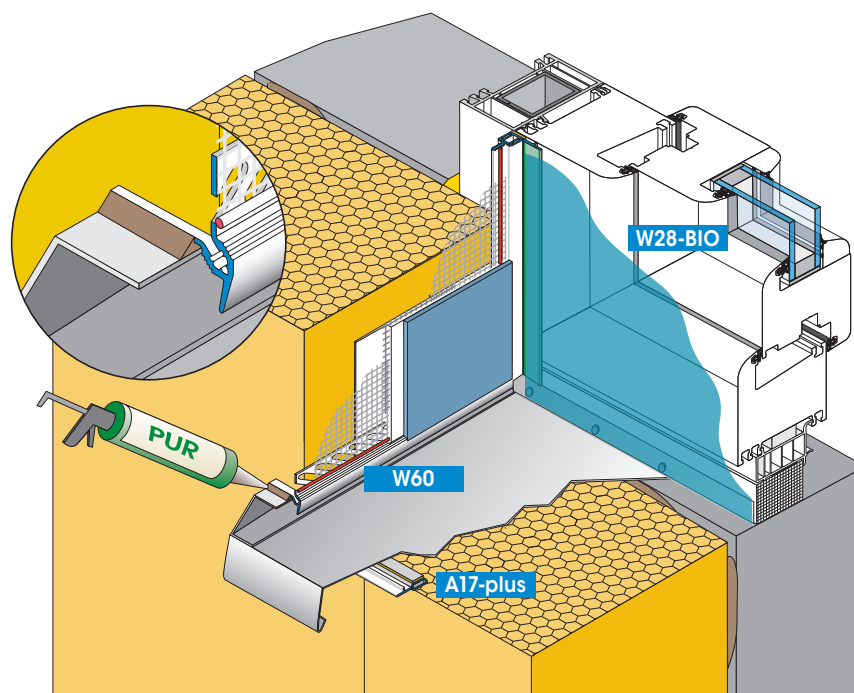

The Connecting Profile SOLI-TEX enables an accurate and sealed plaster border to window sill end caps. The profile is equipped with a self-adhesive PE Sealing Tape and is capable of buffering movements in the window sill. It prevents thermal bridges and noise transmission. The visible self-adhesive PE Sealing Tape cut edge should be sealed on the face side with a permanently elastic gap filler.

This profile is also suitable for plaster joints to shutter housings (see next page). The profile is glued on the projecting metal edge of the housing and connected between 2 profiles with APU Plug Connectors Z13. The APU Connecting Profile W60 can also be used at sheet metal transitions of stepped component parts (e.g. transition from house wall to garage).

If the profile is guided around corners use the intended, prefabricated APU Corner Elements Z18-0.

Available packed unit:

10 bars of 2.10 m = 21.00 m
25 pieces Plug Connectors Z13

For detailed information see technical information sheet or visit us on the Internet at www.apu.ch.

Application example Connecting Profile SOLI-TEX W60 as Drip Edge on shutter housings

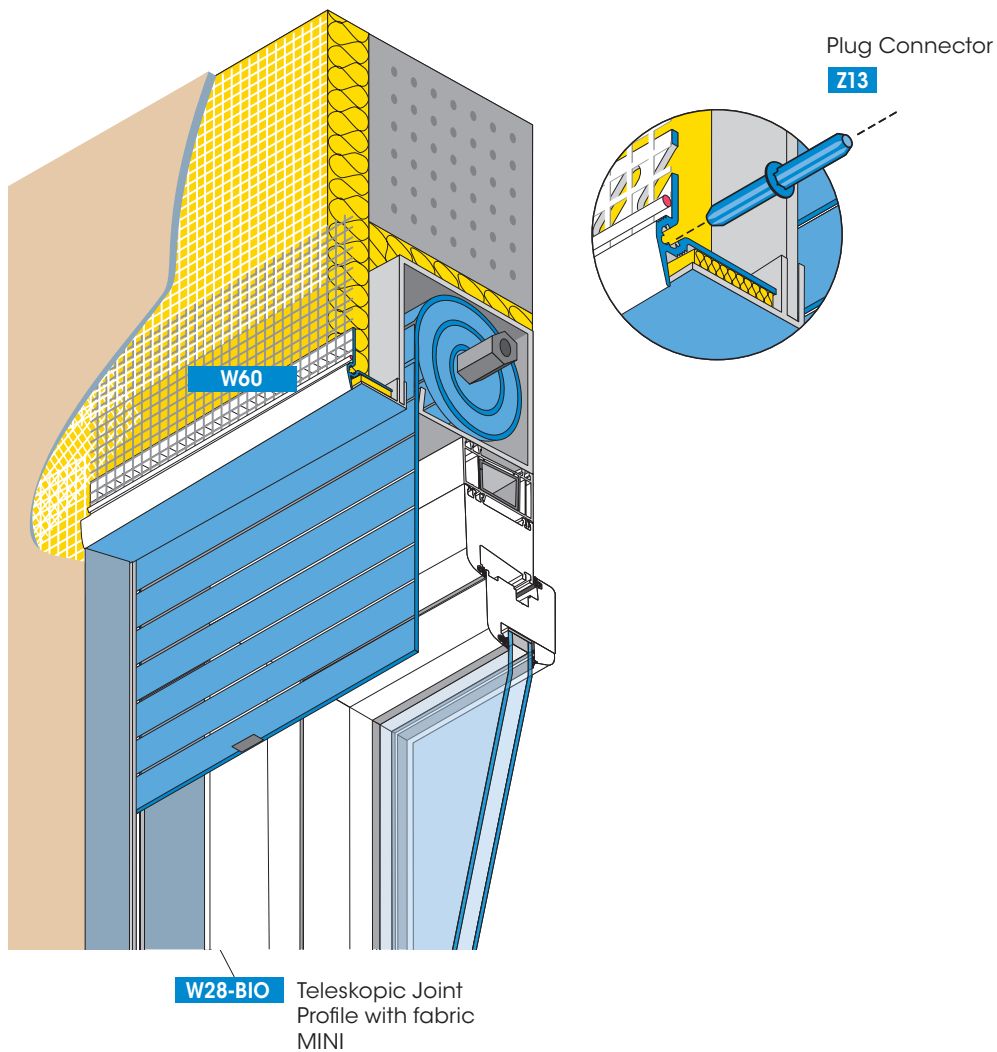

When mounting the Connecting Profiles W60 to shutter housings > 2 m, APU Plug Connectors Z13 must be used.

The Connecting Profiles W60 can also be supplied with imprinted Drip Nose. This is especially necessary if they are to be coated with mineral paints.