

Profiles for external thermal insulation composite systems "ETICS"

W46

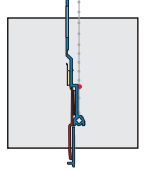

APU Sheet Metal Connecting Profile PUR-FIX

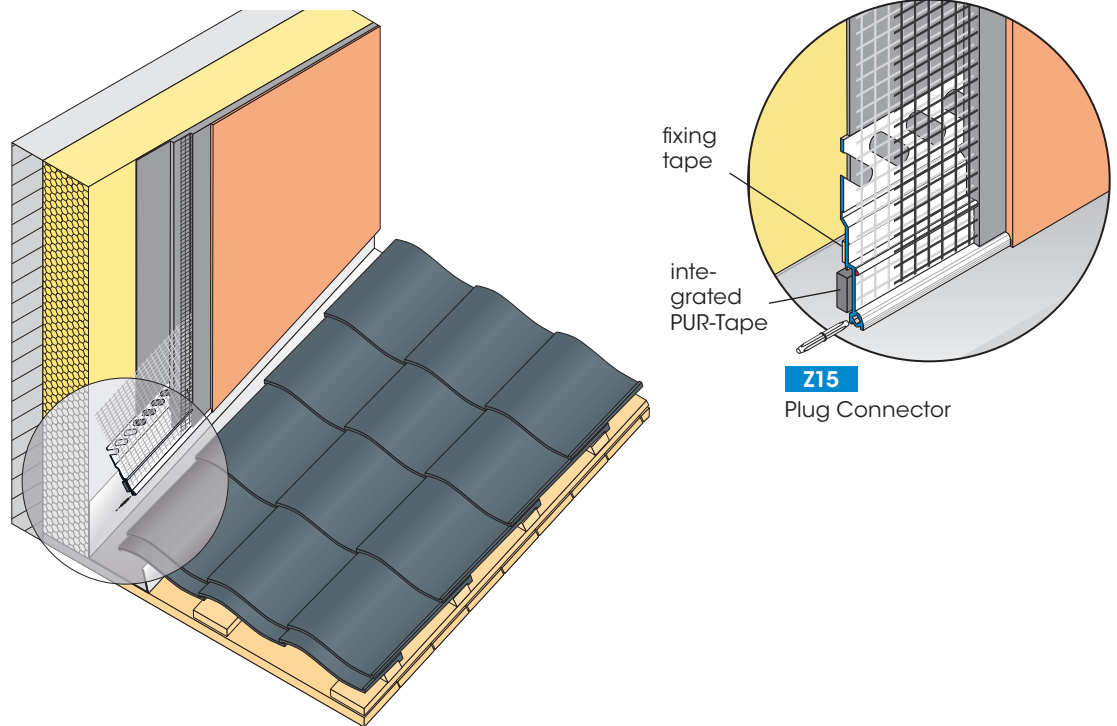

This APU Sheet Metal Connecting Profile PUR-FIX is applied at sheet metal joints (such as roof border-finishing) where movements are expected. The integrated PUR sealing tape enables a movable joint between the plaster and sheet metal.

The profile is equipped with a compressed PUR Sealing Tape, which is released when the protective mechanism is removed and expands directly to the sheet metal, sealing tight against driving rain. The PUR Sealing Tape is longitudinally stuck into the profile and has a projection on both ends to seal the contact area between two profiles. For temporary fixation the profile is additionally equipped with a self-adhesive PE tape. A fabric part of 12.5 cm wide is welded onto the profile with one-sided overhang lengthways.

The profiles are joined together with Plug Connectors Z15 and thus form an aligned flush edge.

**Available packed unit:**

25 bars of 2.00 m = 50.00 m  
Plug Connectors are enclosed

For detailed information see technical information sheet or visit us on the Internet at [www.apu.ch](http://www.apu.ch).