

Profiles for external thermal insulation composite systems "ETICS"

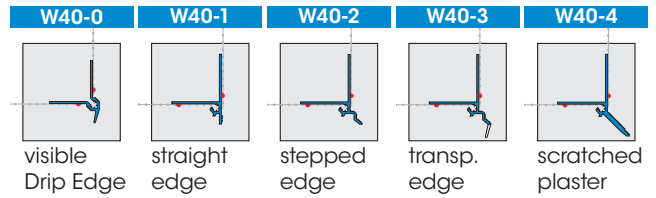

APU Border Profiles DROP-TEX

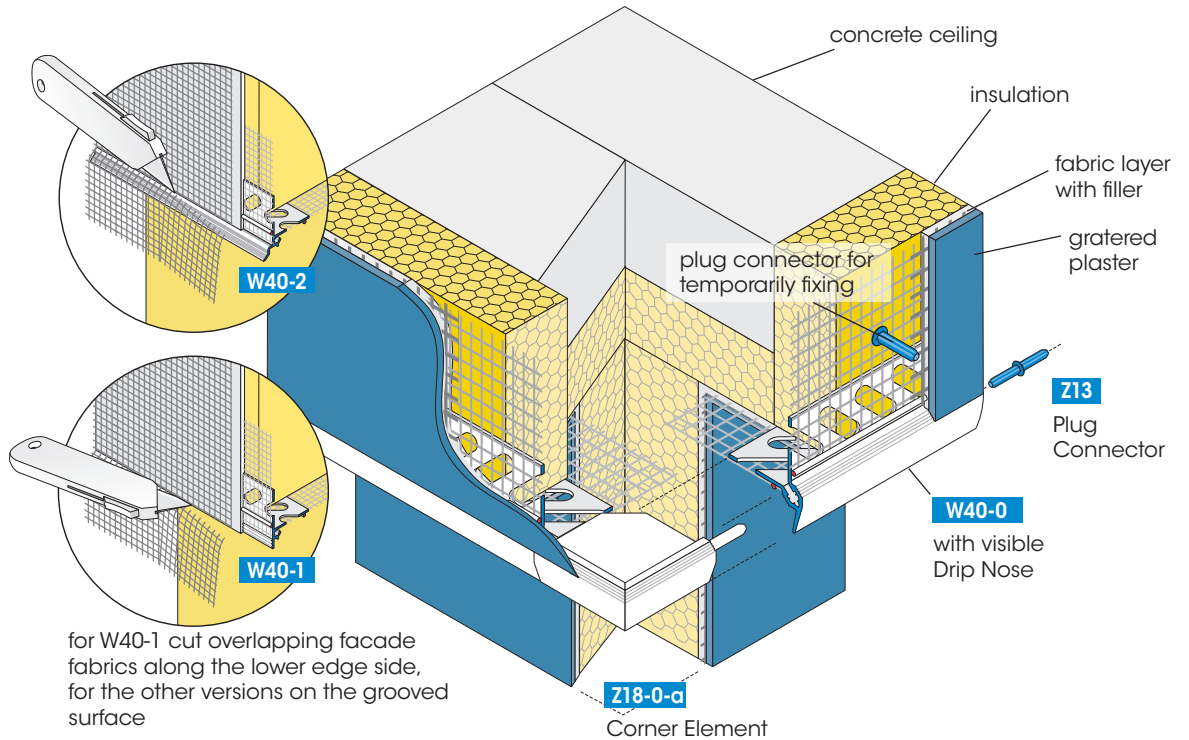

Plaster borders in thermal insulation composite systems also require a secure solution with regard to water-guiding and drainage downwards.

The Border Profiles DROP-TEX are available in different versions (see next page). An appropriate profile can be selected depending on the plaster thickness, for instance. The APU Border Profiles DROP-TEX with Drip Edge are mounted horizontally for plaster borders of retreating building parts such as window and door reveals. The Drip Edge forms either a visible Drop Edge or a plaster flush finish completely plastered over.

The profiles are equipped with two fabric parts each. For improved plaster adhesion the surfaces of the profiles are grooved.

Available packed unit:

25 bars of 2.00 m = 50.00 m
Plug Connectors are enclosed
W40-0/-1/-2 also with suitable Corner Elements:
4x outer and 2x inner corners

For detailed information see technical information sheet or visit us on the Internet at www.apu.ch.

Available Border Profiles DROP-TEX

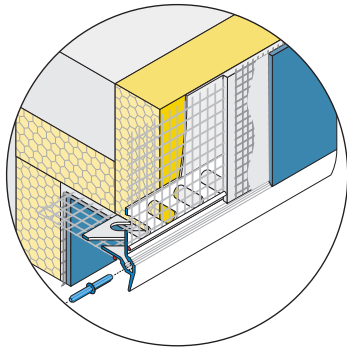

W40-0

DROP-TEX-ZERO

version with visible
Drip Nose

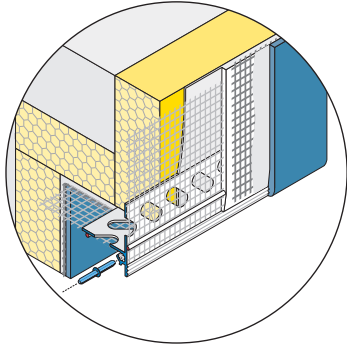

W40-1

DROP-TEX-UNO

version with
straight, covered
Drip Edge

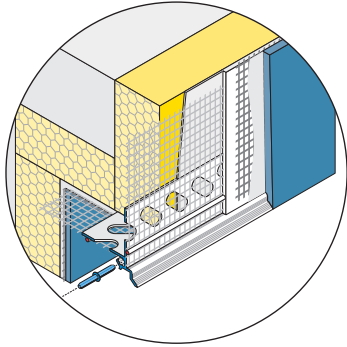

W40-2

DROP-TEX-DUE

version with
stepped, covered
Drip Edge

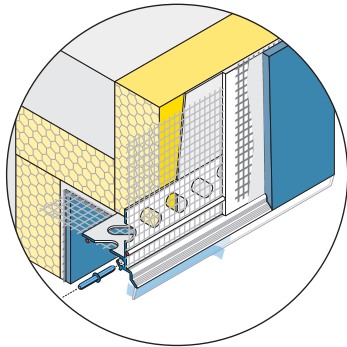

W40-3

DROP-TEX-TRE

version with visible,
transparent Drip
Edge

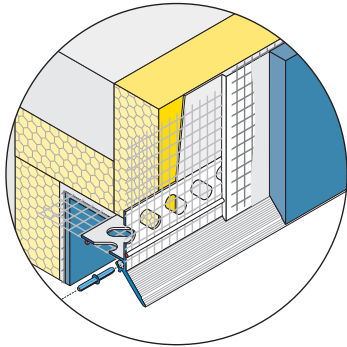

W40-4

DROP-TEX-QUATTRO

version for scratched
plaster with covered
Drip Edge

Optional prefabricated Corner Elements

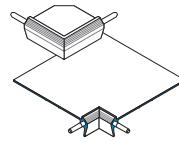

Z18-0-a/i

outer/inner edge for W40-0

10 pieces/bag
10 bags/carton

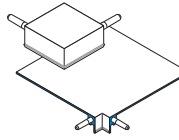

Z18-1-a/i

outer/inner edge for W40-1

10 pieces/bag
10 bags/carton

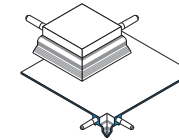

Z18-2-a/i

outer/inner edge for W40-2

10 pieces/bag
10 bags/carton

Corner joints of the profiles W40-3 and W40-4 must be cut to miter (fine saw or Miter-cutting Shears Z11 are useful).

Application at masonry jut

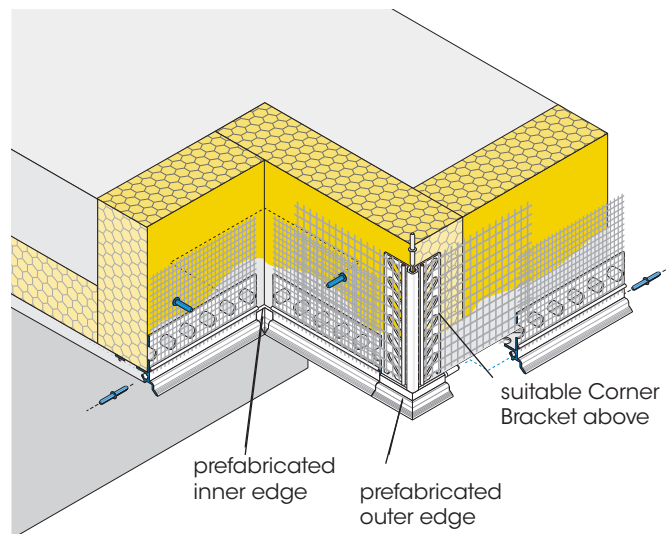

Additional advantages

- prevents thermal bridges from plaster corners
- precise plaster edges
- well-directed water guiding
- enhanced plaster grip by interlocking profile surface
- no fabric shifting
- flush edges with Plug Connectors
- perfect corner areas with prefabricated Corner Elements Z18 (for inner and outer corners)