

Profiles for external thermal insulation composite systems "ETICS"

W37-pro

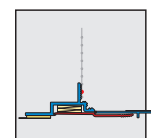

APU Joint Profile with fabric PUR-FIX-pro
with shadow gap

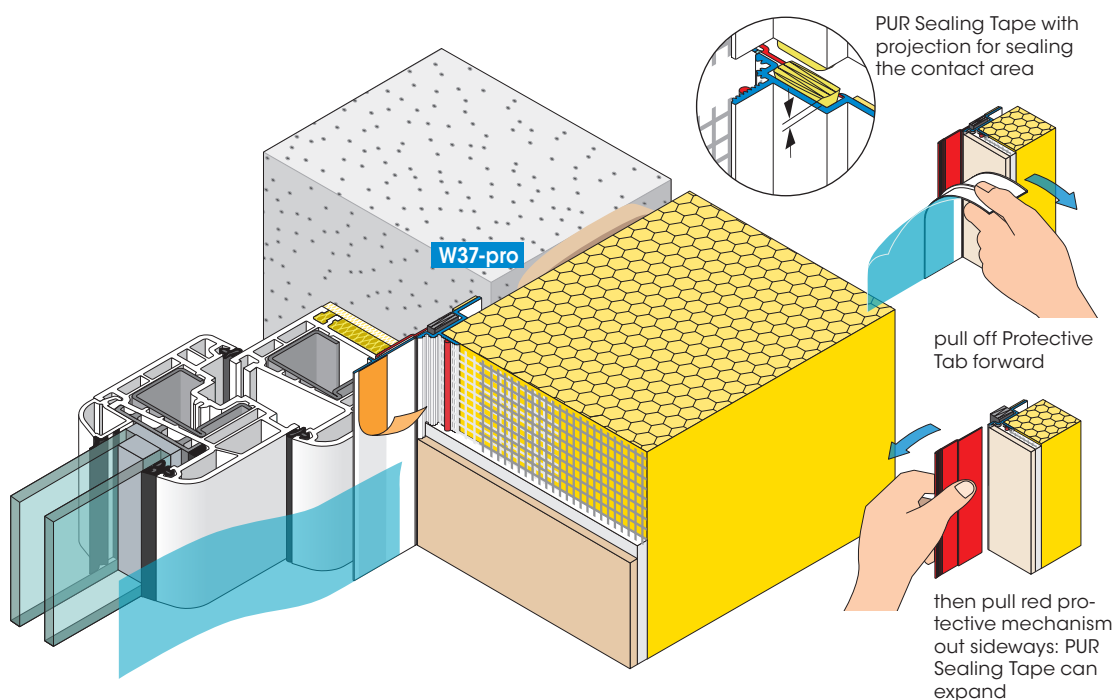

The APU Joint Profile with fabric PUR-FIX-pro is used in ETIC systems and window and door systems where bigger equalization movements are expected. The profile can be aligned and set before the insulation is applied.

The profile is equipped with a compressed PUR Sealing Tape, which is released when the protective mechanism is removed and expands directly to the frame component, sealing tight against driving rain. The PUR Sealing Tape is stuck into the profile and has a projection on both ends to seal the contact area between two profiles. For temporary fixation the profile is additionally equipped with a self-adhesive PE tape. A fabric part of 12.5 cm wide is welded onto the profile bar with one-sided overhang lengthways. The Protective Tab with a self-adhesive tape takes up the on-site protective foil to protect the window during plastering. The Protective Tab can then be pulled off, resulting in a neat plaster edge.

Available packed unit:

25 bars of 2.40 m = 60.00 m

For detailed information see technical information sheet or visit us on the Internet at www.apu.ch. The most up-to-date APU-selection criteria are to be adhered to.

APU AG