

Profiles for external thermal insulation composite systems "ETICS"

W31

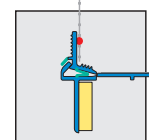

## APU Joint Profile with fabric ROMA

lateral sealing of projecting roller shutter systems

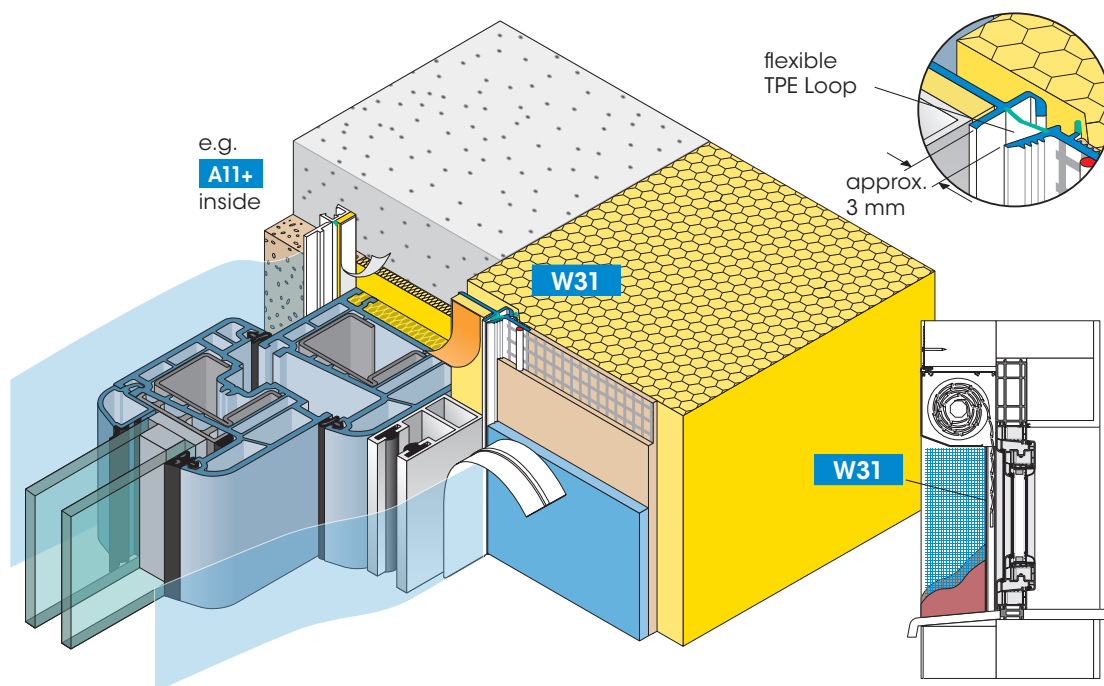

Projecting roller shutter systems are constructed to avoid cold bridges. The inspection flaps are located exterior and the plaster joint is made laterally to the guide rails.

The Joint Profile with fabric ROMA is equipped with a self-adhesive PE Sealing Tape for gluing. The movements resulting from the insulation thickness, overlapping reveal insulation and vibrations are buffered by the coextruded flexible **TPE Loop**. The reveal plastering with fabric layer can be applied in such a way that the inspection flap can be opened and the final plaster is aligned flush with the window sill border caps. The expandable TPE Loop is released by tearing off the Protective Tab.

The lateral and top joints must be selected depending on the construction situation and shape of the inspection box (example, see next page).

### Available packed unit:

25 bars of 1.40 m = 35.00 m  
25 bars of 2.40 m = 60.00 m

For detailed information see technical information sheet or visit us on the Internet at [www.apu.ch](http://www.apu.ch). The most up-to-date APU-selection criteria are to be adhered to.

## Construction example projecting roller shutter system

Professional joint due to all-round sealing with the APU profiles W31 and W36+, supplemented by Corner Bracket with fabric W11.

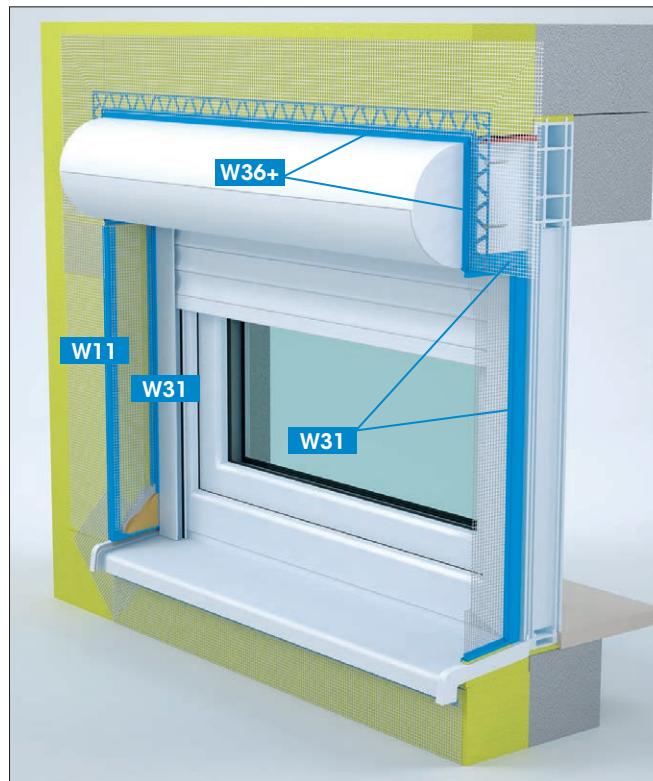

### Sectional drawings

