

Profiles for external thermal insulation composite systems "ETICS"

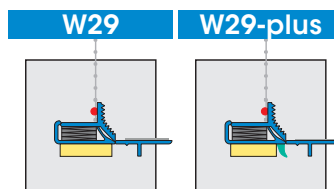

APU Joint Profile with fabric PUR-EX/-plus with compressed PUR Sealing Tape

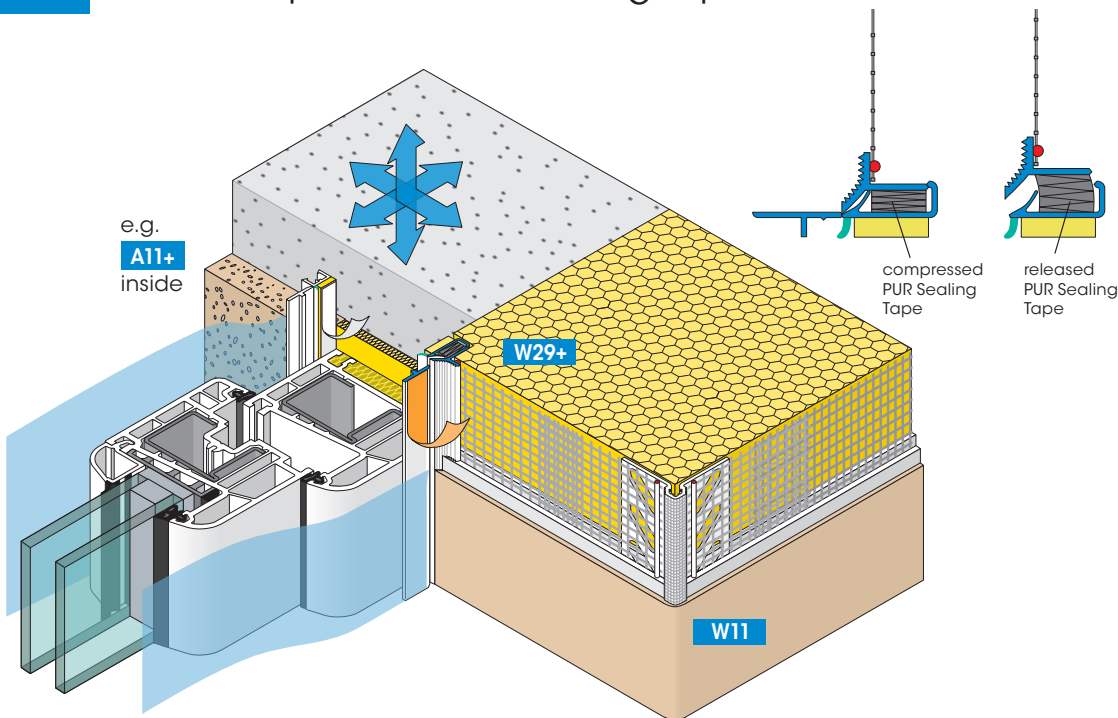

The APU Joint Profile with fabric PUR-EX (and PUR-EX-plus - with a soft Protective Lip) is equipped with a compressed and pushed in PUR Sealing Tape which is released by removing the Protective Tab, and expands freely as required. It provides a **decoupled (*) solution** between plaster system and the framework.

The profile is provided with a **welded on fabric part**. The front edge is arched and grooved to give the plaster a well aligned fitting. The compressed PUR Sealing Tape is calculated in safe dimensions, is **driving rain proof** and protected by a covering bar. The profile is provided with a self-adhesive PE Sealing Tape for gluing to the frames.

The profile W29 PUR-EX is applicable in thermal insulation composite systems "ETICS" with insulation thickness > 100 mm (especially for low-energy/passive houses) and to window/door systems where equilization movements are expected.

Available packed unit:
 25 bars of 1.40 m = 35.00 m (on request)
 25 bars of 2.40 m = 60.00 m

For detailed information see technical information sheet or visit us on the Internet at www.apu.ch. The most up-to-date APU-selection criteria are to be adhered to.

Application examples

Fire protection in the lintel area with a plaster pan

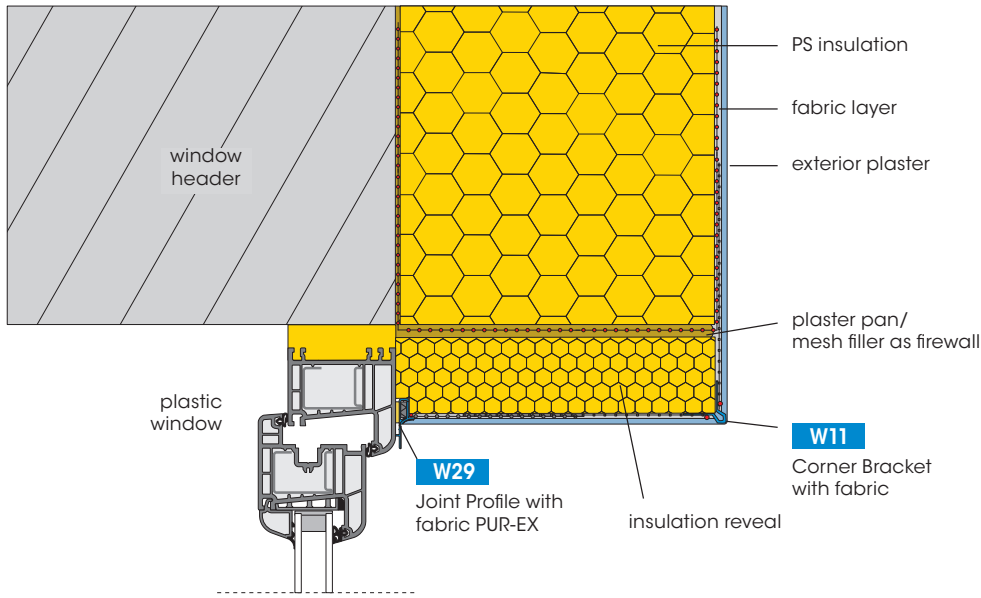

Application in plastic warm window

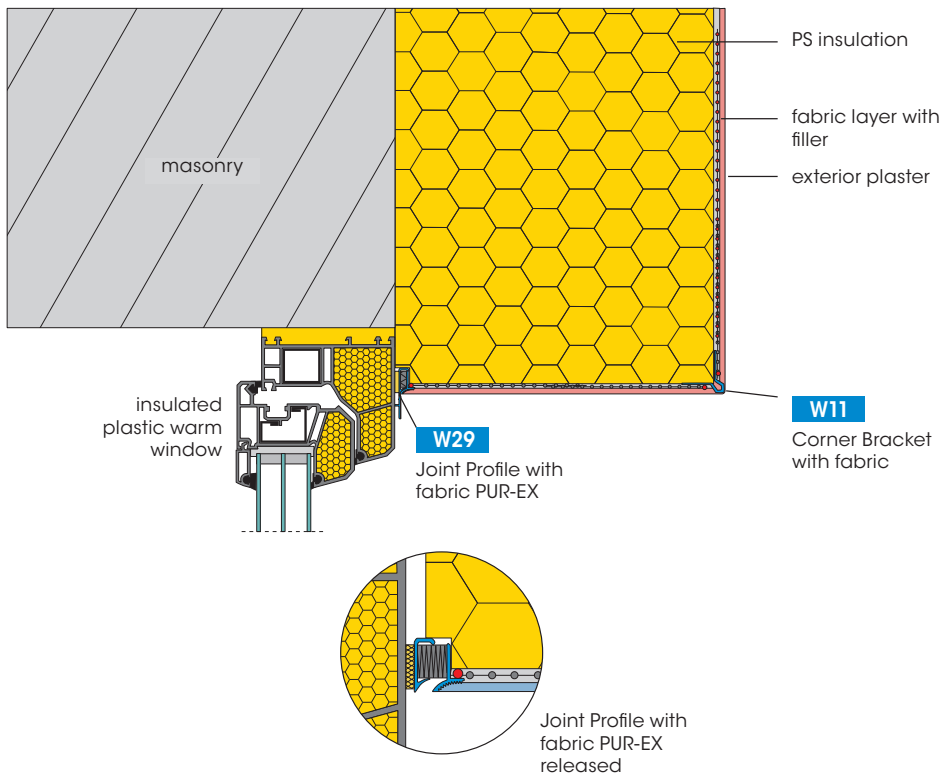

APU[®] APU[®] APU[®]