

Profiles for external thermal insulation composite systems "ETICS"

W17

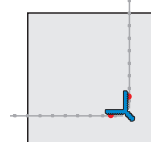

APU Corner Bracket with fabric MINI also for curves

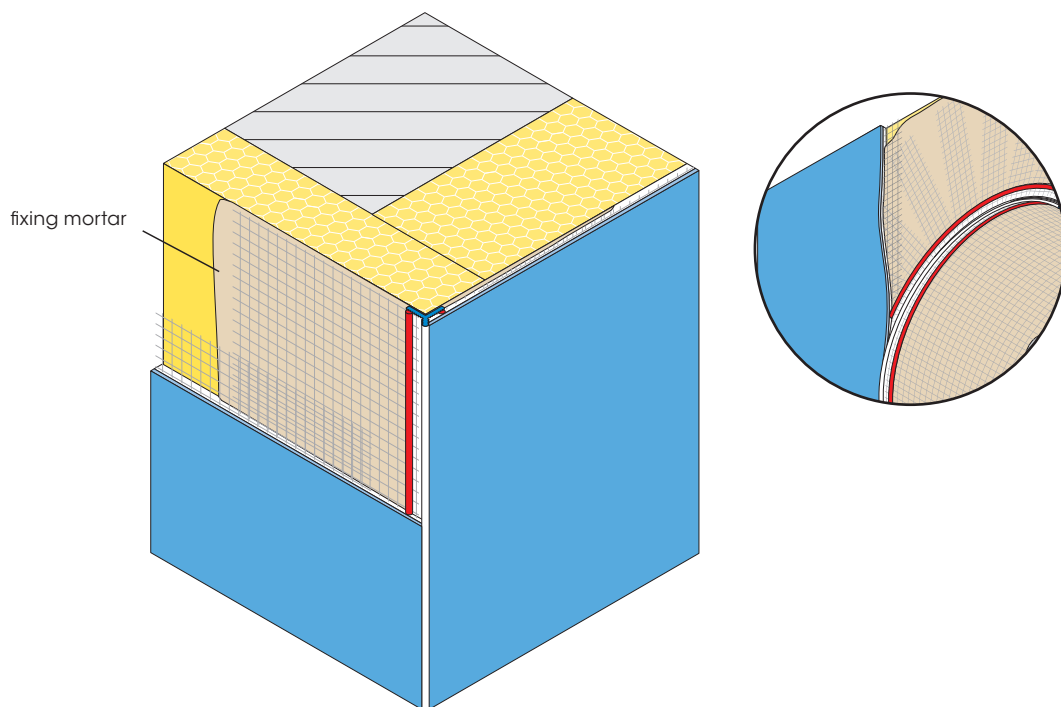

The APU corner bracket with fabric MINI is suitable for fine and thin layer plasters. The bracket is bendable if needed, and therefore suitable for curves.

The corner bracket with fabric is equipped with welded-on fabric parts of each 12.5 cm wide. The fabric projection of 10 cm provided at one end of the bracket lengthwise allows overlapping of the fabric parts in the contact area between two profiles. A grooved plaster level bar makes it easier to attach the final rendering, forming an exact, flush edge.

**Available packed units:**

25 bars of 2.50 m = 62,50 m

For detailed information see technical information sheet or visit us on the Internet at [www.apu.ch](http://www.apu.ch).