

Profiles for external thermal insulation composite systems "ETICS"

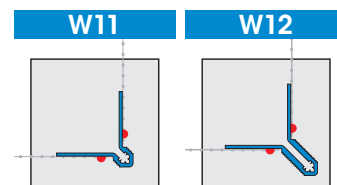

APU Corner Bracket with fabric DUO-TEX

with plaster level bars, fabric welded on

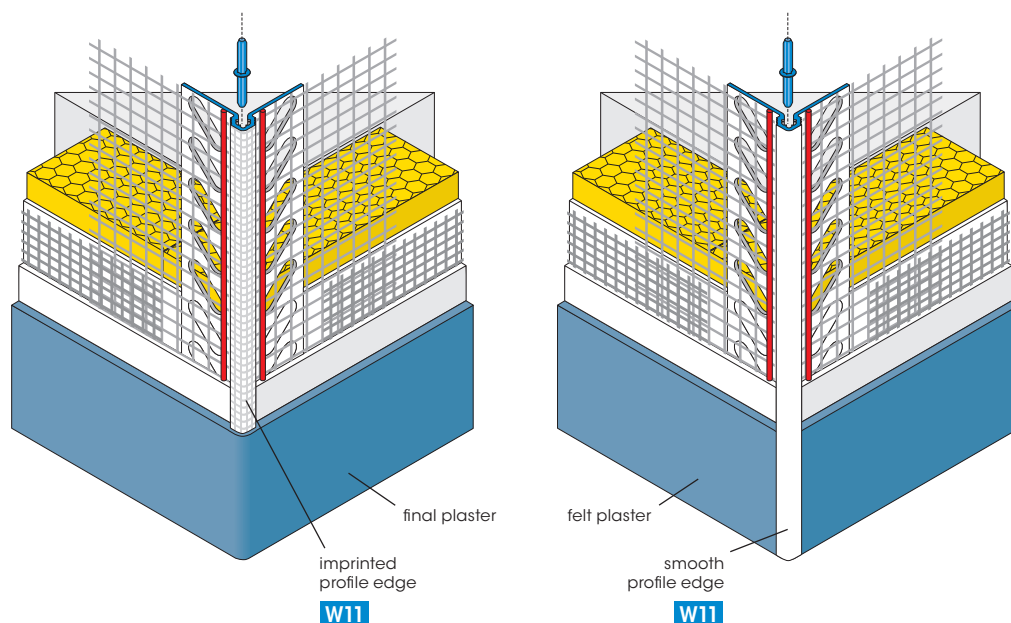

The Corner Brackets with fabric DUO-TEX form aligned and shock-resistant edges in thermal insulation composite systems.

The fabric parts are welded on the Corner Bracket using welding cords in ultrasonic method. At the same time the welding cords act as plaster level bars which ensure uniform coating thickness of the filler. This makes it much easier to strip off the filler.

The projecting profile edge prevents cold bridges to the plaster and can be plastered over (version with imprinted / rough edge). The plaster level bar ensures correct layer thickness of the entire plaster system. For felt plaster the smooth profile edge is used. The smooth profile edge can be painted.

The Corner Brackets with fabric are connected together with Plug Connectors Z13, then embedded and fully covered with the filler.

#### Available packed unit:

**Version W11 smooth or imprinted for fine plaster:** 2.00 m, 25 bars/bundle = 50.00 m,  
**Version W12 scratch plaster:** 2.00 m, 25 bars/bundle = 50.00 m,  
 (connectors in a bag of 25 pieces)

## Application example

The Plug Connectors can also be used for temporary fixing when aligning the Corner Bracket with fabric. After applying the fabric filler they can be pulled off or hammered into the insulation.

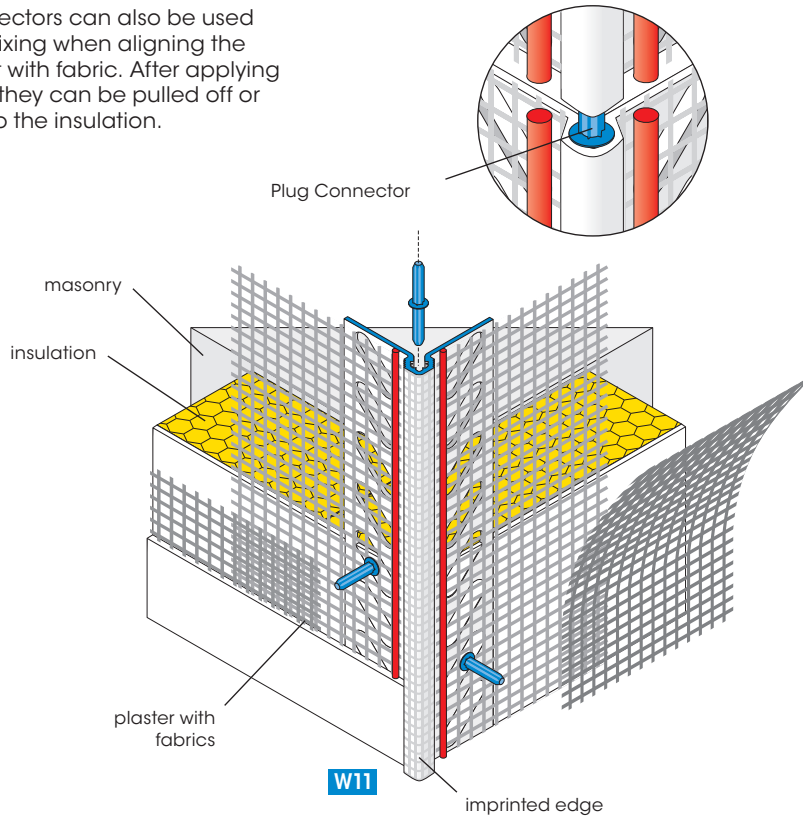

### Additional advantages

- prevents cold bridges from the edges to the plaster
- exact plaster leveling
- reinforced bump edge
- plaster gripping on the imprinted profile surface
- no shifting of fabric
- perfectly aligned corners
- perfect joint through Plug Connectors
- easy to process with Trimming Shears

### APU Corner Bracket with fabric DUO-TEX W12

#### Application with scratch plaster

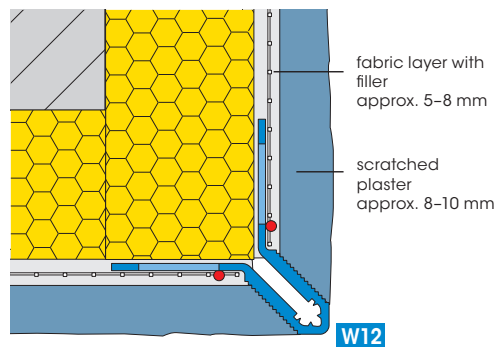

For detailed information see technical information sheet or visit us on the Internet at [www.apu.ch](http://www.apu.ch).