

Profiles for interior and exterior plastering

A11

A11-plus

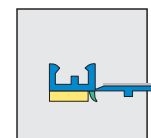
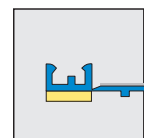

APU Fillet MINI (plus)

plaster joints to windows, doors and for reconstruction work with thin-coated plastering

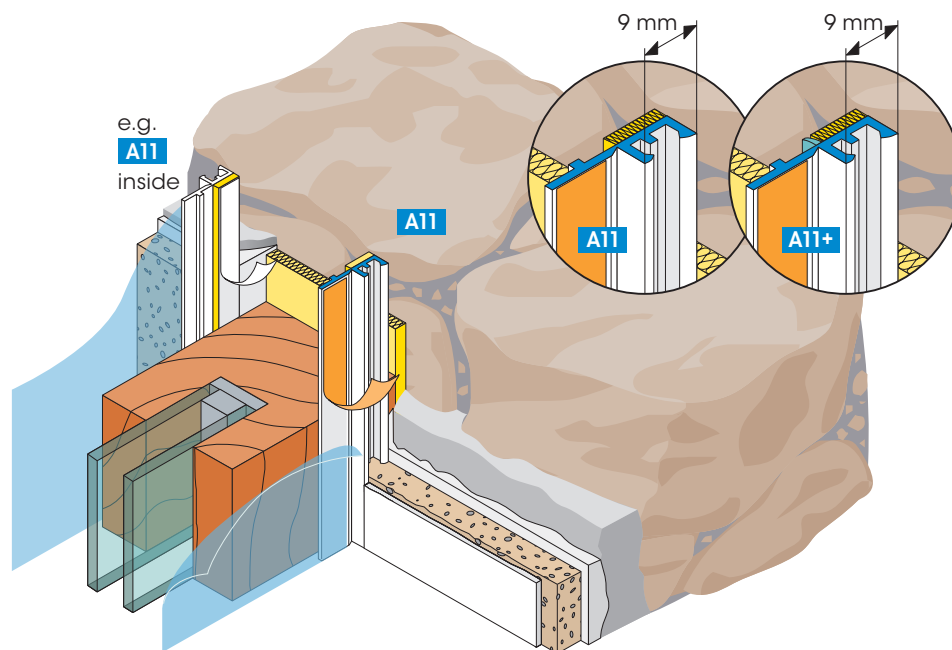

Reworked plaster surfaces and internal plasters require compact and secured plaster joints to doors, windows and other component parts. The MINI (and MINI plus) fillets seals by pressing it onto the component. The self-adhesive PE Sealing Tape forms a durable UV-resistant movement joint.

The plastic profile is the permanent joint between the plaster coating and the component parts. During the plastering work a protective foil is fixed to the self-adhesive Protective Tab. A neat plaster border is the result after removing the Protective Tab.

The APU fillet is available as MINI with a self-adhesive PE Sealing Tape and MINI-plus with a self-adhesive PE Sealing Tape and soft Protective Lip.

The fillet is driving rain proof as tested and certified by EMPA No.173557. Component test pursuant to iff test report no. 104 28679.

Available in packed units:

A11: 20 bars of 1.40 m = 28.00 m

A11: 20 bars of 2.40 m = 48.00 m

A11+: 20 bars of 1.40 m = 28.00 m

A11+: 20 bars of 2.50 m = 50.00 m

For detailed information see technical information sheet or visit us on the Internet at www.apu.ch. The most up-to-date APU-selection criteria are to be adhered to.