

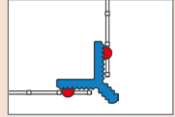

W17



APU®

PROFILES FOR COMPOUND HEAT INSULATION SYSTEMS

Corner bead with mesh

MINI

Grooved with 2 x 12.5 cm mesh

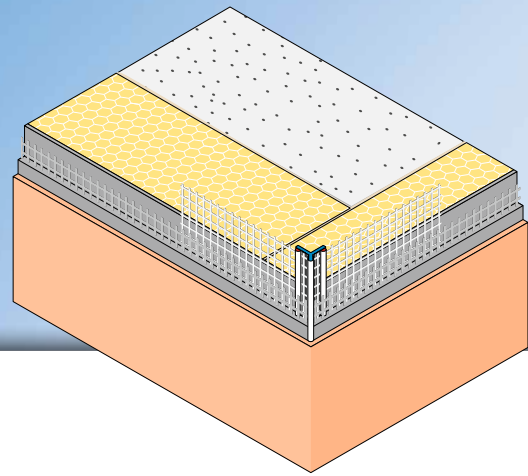

The **APU corner bead with mesh MINI** is used in compound heat insulation systems as a flush, impact-protected edge for thin top layers of plaster. If necessary, the bracket can be bent and thus made suitable for curves.

The corner bracket has 2 wings to each of which a strip of mesh is welded. Each bar has a fabric overhang on one side of 10cm in the lengthways direction. The ribbed skimming bar makes applying the system of plaster easier and forms a clean corner guard in the area of the corner.

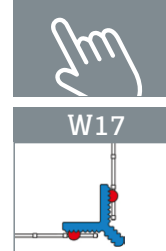

Fitting

- 1 Apply c. 15 cm of filler compound / reinforcement plaster compound up to the edge of the insulation material on left and right.
- 2 Embed corner bead with mesh flush into the reinforcement base plaster and align.
- 3 For curves, the mesh must be cut prior to embedding in such a way that it is not under any tension. (Test desired radius before applying layer of reinforcement base plaster.)
- 4 Apply reinforcement base plaster over the full area. In doing so, pull the mesh up to the plaster edge and trim.
- 5 After leaving to stand for the required time, apply final coat of plaster.

Important information

- Any applications not clearly described in the documents may be implemented only after consultation with the plaster or ETICS manufacturer.
- When the work is being done, the surface temperature must be at least +5 degrees and must not exceed +40 degrees.
- After being set in place on the structural element, profiles with a mesh vane must be promptly embedded. Until then they must be protected from the weather.
- The surface mesh to be subsequently attached must be run up to the skimming edge of the profile.
- The processing guidelines of the plaster manufacturer shall be complied with.