



W46

APU[®]

PROFILES FOR COMPOUND HEAT INSULATION SYSTEMS

Flashing bead PUR-FIX

With 12.5 cm mesh

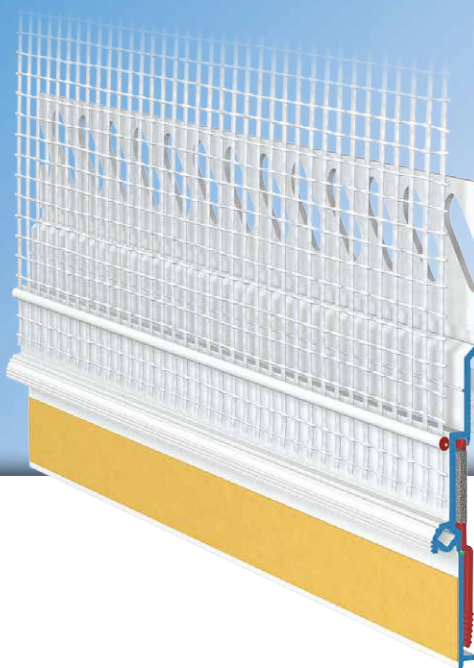

The **APU flashing bead PUR-FIX** is used at junction points with metal plate in compound heat insulation systems (e.g., at junctions with the roof's edge) and as a result of its integrated PUR sealing strip produces a flexible connection between plaster and metal. When the plaster work is finished, the profile ensures that water is accurately guided away.

The profile comes with an expanding PUR sealing strip, which ensures a watertight, lasting seal without any sticking directly to the structural element. Self-adhesive PE tape is applied to fix the profile to the component. The profile has a welded fabric strip. Each bar has a fabric overhang on one side of 10cm in the lengthways direction. The included plug connectors (Z15) enable the profiles to be joined and fitted very precisely and flush. What is created after completion of the plastering work is a clean termination of the plaster.



W46



Design

	ITEM NO.	LENGTH	PACKAGING UNIT	WEIGHT (per PU)
--	----------	--------	----------------	-----------------

PUR-FIX flashing bead

W46 With 12.5 cm mesh	W46-2000	2.0 m	25 bars = 50 m	11 kg
--------------------------	-----------------	-------	----------------	-------

Features

	PUR-FIX FLASHING BEAD
Material	<ul style="list-style-type: none"> ■ Rigid PVC manufactured under DIN-16941
Protective flap	<ul style="list-style-type: none"> ■ Detachable with soft TPE connection and double-sided self-adhesive tape
Fixation	<ul style="list-style-type: none"> ■ PE foam tape 6 x 1 mm
Seal	<ul style="list-style-type: none"> ■ PUR sealing strip, 10 mm, type BG1 ■ Watertight (against driving rain) for joints of up to 4 mm
Mesh	<ul style="list-style-type: none"> ■ Min. 160 g/m² approved for compound heat insulation systems ■ 12.5 cm wide – MW 4 x 4 mm ■ Ultrasonic welded
Accessories	<ul style="list-style-type: none"> ■ Z15-0000 Plug connectors (1 bag)
Corner pieces	<ul style="list-style-type: none"> ■ Z46-A-1010 External corners (10 pieces) ■ Z46-I-1010 Internal corners (5 pieces)

Important information

Storage	Always store profiles laid down in a dry place.
Other applications	Any applications not clearly described in the documents may be implemented only after consultation with the plaster or ETICS manufacturer.
Flashing strip	Where the profiles are used above 3m length, a flashing strip must be used above the sheet metal.

For information on materials, areas of use, tests and correct application, please refer to our 'General Advice and Information'



W46



Details

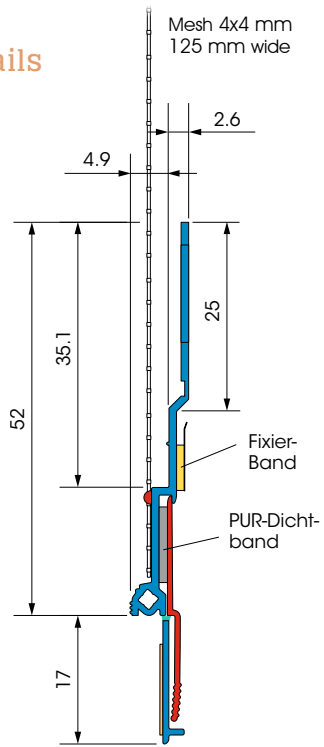

Sectional drawing in mm

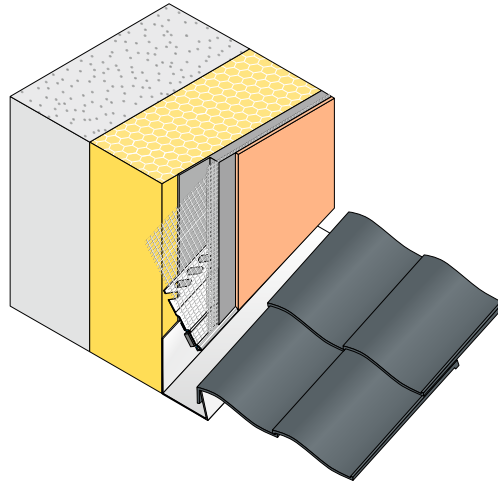

Application drawing