

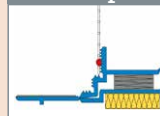

W29 - pro

**APU**[®]

PROFILES FOR COMPOUND HEAT INSULATION SYSTEMS

Window reveal bead with mesh

PUR-EX-pro

With shadow gap and 12.5 cm mesh

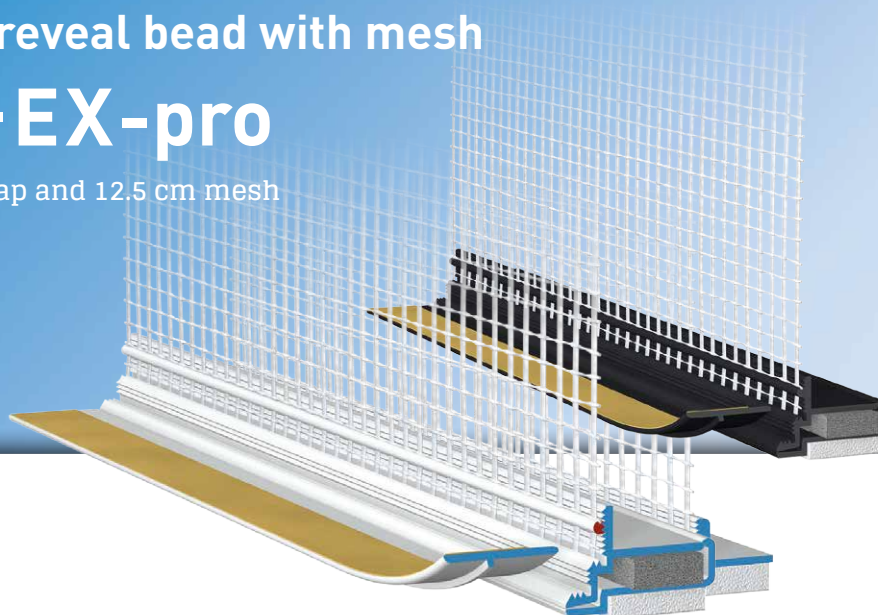

The **APU window reveal bead with mesh PUR-EX-pro** is used in compound heat insulation systems as specified in the latest APU selection criteria. Within the reveal the profile is stuck flush to the structural element there and thus forms a clean and reliable termination of the plaster with shadow gap.

The profile comes with a self-adhesive PE foam tape, which ensures a watertight, lasting seal. The PE foam tape is covered and protected by the profile contour. The integrated expanding PUR sealing strip is able to absorb relatively large movements in the area around the joint. This is activated by removing the protective flap. There is a fabric window reveal bead welded onto the profile. Each bar has a fabric overhang on one side of 10cm in the lengthways direction. There is a piece of self-adhesive tape on protective flap in order to secure the third-party protective film. This protects the window during the plastering work. After completion of these tasks, the protective flap is pulled off and what is created is a clean edge to the plaster.

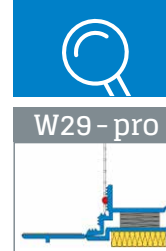

Design

	ITEM NO.	LENGTH	PACKAGING UNIT	WEIGHT (per PU)
--	----------	--------	----------------	-----------------

PUR-EX-pro window reveal bead with mesh

W29 - pro				
With shadow gap and 12.5 cm mesh	W29-24PRO	2.4 m	25 bars = 60 m	11.5 kg
Grey, similar to RAL 7016	W29-24PRO-7016	2.4 m	25 bars = 60 m	11.5 kg

Features

	PUR-EX-PRO WINDOW REVEAL BEAD WITH MESH
Material	<ul style="list-style-type: none"> ■ Rigid PVC manufactured under DIN-16941
Protective flap	<ul style="list-style-type: none"> ■ Detachable with soft TPE connection and double-sided adhesive tape
Features	<ul style="list-style-type: none"> ■ PUR sealing strip, 10 mm, type BG1 ■ Watertight for joints of 3-9mm
Seal	<ul style="list-style-type: none"> ■ PE foam tape 14 x 4 mm
Mesh	<ul style="list-style-type: none"> ■ Min. 160 g/m² approved for compound heat insulation systems ■ 12.5 cm wide – MW 4 x 4 mm ■ Ultrasonic welded
Inspections	<ul style="list-style-type: none"> ■ VDPM leaflet: Class A with adhesive connection ■ Ö-Norm 6400-2: Class III

Important information

Storage	Always store profiles laid down in a dry place.
Test of adhesion	Perform adhesion test. ▶ See general tips – APU test of adhesion
Other applications	Any applications not clearly described in the documents may be implemented only after consultation with the plaster or ETICS manufacturer.
Selection criteria	Adhere to the latest APU selection criteria. ▶ see APU selection criteria

For information on materials, areas of use, tests and correct application, please refer to our 'General Advice and Information'

Details

